

Diamond Wedge Scribe

Features

- Cleave Bare Fiber to Produce Optical Quality Surfaces
- Scribe Excess Fiber from the Connector Ferrule in Preparation for Polishing
- 90° Wedge-Shaped Diamond Tip Preferred by Most Fiber Technicians
- Protective Cap Included

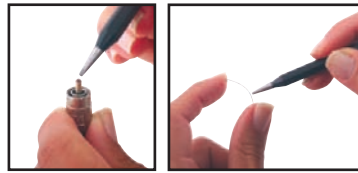

| ITEM # | \$ | £ | € | RMB | DESCRIPTION |
|--------|----------|---------|---------|----------|---------------------------------|
| S90W | \$ 61.50 | £ 44.28 | € 53,51 | ¥ 490.16 | 90° Wedge-Shaped Diamond Scribe |

Reusable Fiber-to-Fiber Splice

Specifications

- Average Splice Loss: 0.2 dB
- Fiber Jacket Size Range: Ø250 - Ø900 µm (Both Models)
- Fiber Retention: >1250 g
- Installation Time:* <60 s

*See www.thorlabs.com for installation instructions.

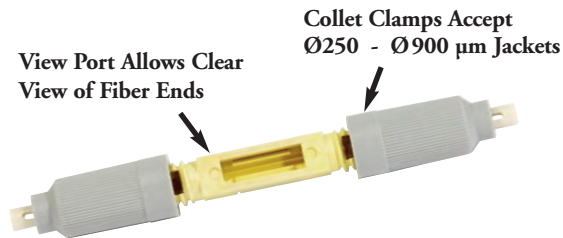

These easy-to-use fiber-to-fiber splices offer high performance (~0.2 dB average splice loss) in a reusable package. The glass capillary alignment tube comes pre-loaded with our index-matching gel featured below. The fiber location within the glass capillary can be monitored through a central view port.

| ITEM # | \$ | £ | € | RMB | DESCRIPTION |
|--------|----------|---------|---------|----------|--|
| TS125 | \$ 18.50 | £ 13.32 | € 16,10 | ¥ 147.45 | Single Mode Fiber-to-Fiber Splice, Ø125 µm Cladding Size |
| TS128 | \$ 18.50 | £ 13.32 | € 16,10 | ¥ 147.45 | Multimode Fiber-to-Fiber Splice, Ø128 µm Cladding Size |

Index-Matching Gel



- Minimizes Back Reflections in Fiber-to-Fiber Splices
- Stays a Gel (Does Not Cure)

| λ (nm) | n* |
|--------|-------|
| 632.8 | 1.456 |
| 840.0 | 1.451 |
| 1064.8 | 1.449 |
| 1300.0 | 1.448 |
| 1550.0 | 1.447 |

*Index of Refraction @ 25° C

This index-matching gel may be used to couple optical signals into or out of optical fibers. When coated onto the fiber cladding for use as a mode stripper, it will strip out the signal carried in the cladding. The gel is stable over a wide temperature range, with a freezing point of -67 °C and a boiling point in excess of 416 °C. Note that this material will always remain a gel as it does not cure or harden.

| ITEM # | \$ | £ | € | RMB | DESCRIPTION |
|--------|----------|---------|---------|----------|------------------------------------|
| G608N | \$ 30.90 | £ 22.25 | € 26,88 | ¥ 246.27 | 1 mL Syringe of Index-Matching Gel |

Wash and Dropper Bottles

Plastic wash bottles are made for specific liquids. The name of the liquid is silk-screened on the bottle with color-coded caps.

The small eye dropper bottles are recommended for dispensing cleaning fluids for laser grade optics. Both the bottles and droppers are glass.



Special Note:

Wash and dropper bottles sold empty; please contact your local chemical supplier for solvents.

| ITEM # | \$ | £ | € | RMB | DESCRIPTION |
|--------|----------|---------|---------|----------|---|
| B2939 | \$ 63.30 | £ 45.58 | € 55,07 | ¥ 504.50 | Kit: 4 Wash Bottles and 3 Glass Dropper Bottles |